

contribution form

I would like to support the Bodhi Eco Project

Full Name _____

Address _____

Postcode _____

Telephone _____

E-mail _____

Skills I can offer _____

Donation enclosed: £ _____

(Please make cheques payable to "Bodhi" and send to address below)

GIFT AID IT

If you are a UK tax-payer, please consider ticking the Gift Aid box below. At no extra cost to yourself, you are increasing your donation to Bodhi by 28%. Please note that by ticking this box you are agreeing with the following statement:

I wish the Bodhi Eco Project to claim back the tax on any donations from myself from 23/10/2006 until I notify you otherwise. I confirm that I am a UK tax-payer and have paid Income Tax or Capital Gains Tax at least equal to the amount Bodhi will claim back from the Inland Revenue.

*please note that to claim Gift Aid we need your full name e.g. Jo Brown (rather than Mrs Brown), your house number and your post code (NB c/o work addresses, sports centres etc mean we cannot claim back your Gift)

Signature _____

Date _____

Please note that your personal information will only be used to keep you informed about Bodhi events/news and will not be passed on to third parties (in accordance with the Data Protection Act 1998)

Please complete and send this form to:

bodhi eco-project
(2/1) 14 Garrioch Drive,
GLASGOW
G20 8RS

Registered Charity No. SCO96376

benefits for supporters

As a Bodhi supporter you become an associate member and will:

- Receive invitations to our meetings, retreats and events.
- Get information about our progress by regular news bulletins.
- Have access to our internet forum where you can post your ideas.
- Share the journey of creating the Bodhi village and perhaps living in it.

Another step in reducing your ecological footprint!

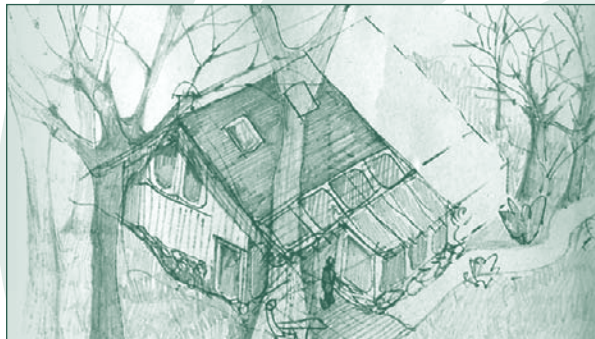

A partially dug-in house with solar panels

For further information contact:
info@bodhi-eco-project.org.uk

or visit our website:
www.bodhi-eco-project.org.uk



Supported by

The National Lottery[®]
through Awards for All



please recycle
Printed on 100% recycled paper

designed by donna@ezppl.com

bodhi eco-project



practice of ethics
care for the earth
creative arts

imagine creating a life together ...

where are we at?

Spring 2007 we are now a registered Scottish charity and a limited company. We have made presentations to five Local Authority Planning Departments to establish where our project meets most support, and we will begin looking for land within the next 18 months.

Over the last three years we received donations from over 130 individuals and £17,000 in grant awards. The interest continues to grow.

Our current aims include:

- Increasing membership, especially young people
- Establishing an office base - employing a project manager; administrator; and education officer
- Further presentations to Local Authorities and Housing Associations with a view to partnership
- Providing training in Permaculture; Non-Violent Communication; and Ecology
- Honing skills in 5 Rs (Recycling, Reusing, Refusing, Reducing and Repairing) and carrying out site-specific feasibility studies

how can I get involved?

Whether you are attracted to living in the village or simply want to support the project, we greatly welcome your contributions of enthusiasm, experience, skills and money. To become a Bodhi supporter please complete the contribution form overleaf.

We have an ongoing programme of events where we would be delighted to meet you:

- Training events in permaculture, non-violent communication and ecology
- Retreats
- Festivals
- An ecovillage design study group
- Presentations/stands at large events



Some members of the core team.

“Never doubt that a small group of committed citizens can change the world.”

Margaret Mead

“Be the change you want to see in the world.”

Gandhi

“The best way to make your dreams come true is to wake up.”

Paul Valery

*together we can
make this real!*

- ♥ in an eco-village amidst the natural beauty of Scotland
- ♥ affordably owning/renting your eco-home on communally owned land/resources
- ♥ with others who meditate and practice kindness, generosity, honesty and simplicity in their daily life
- ♥ in a predominately vegetarian village, growing some of our own food and conserving land and water
- ♥ with access to arts and crafts studio facilities and shared exhibition and performance spaces
- ♥ with minimum waste and carbon emissions and caring for the earth's resources through renewable energy systems
- ♥ with a shared transport system
- ♥ with people of all ages and from a diversity of life styles
- ♥ on the basis of consensus decision making in combination with an elected village council
- ♥ sharing our experience with the wider community through work, education, and celebratory events